

WINTER 2023

# WESTHORSLEY.INFO

News and information from West Horsley Parish Council

## THEN AND NOW CHANGES AROUND THE VILLAGE

### IN THIS ISSUE



Then & Now – for Better or for Worse Special



Say No to Wisley – A fictional story?



Youth Council = Cinema Event by the Youth Council



West Horsley Place - Researching WWII





# HELLO FROM THE WHPC CHAIRMAN

## Welcome to our 2023 Winter Newsletter

It's hard to believe 2023 is nearing its end but then it's been a very busy year and time does fly! Not surprising therefore that our theme for this Christmas / Winter newsletter is "Then and Now". We have much to celebrate and comment on throughout this edition which I hope you will find interesting.

I'd like to welcome Karen Young, our new Deputy Clerk, who has taken over from Jane McKenzie whom, I'm delighted to say, decided to move tables, and become a Parish Councillor. Jane will be leading our work on roads, road safety and footpaths. I'd also like to welcome Dennis Booth as our new Surrey County Councillor. Taxing us still is the impact on our infrastructure with all the housing developments that centre on our Village and working with Dennis will be very important. There was little more we could do about available school places but were reassured by the leaders of our local health services that the population increase would not have an adverse effect on the services we currently use. This, of course, excludes the proposed Wisley Development which is currently at Appeal stage before the Planning Inspector. I'd like to thank all those of you who have written in about this development and made submissions to the Hearing; your time and efforts have been greatly appreciated.

A particular highlight this Autumn was the unveiling of the restored Mulberry Room, Her Grace The Duchess of Roxburghe's bedroom, at



*Cllr Elaine Best*  
chairman@westhorsley.info

West Horsley Place. The concept and project was inspired by Sarah Christiansen and undertaken by the Glad Rags Group. The quilting, needlework and painting are exquisite; the whole restoration of the room is beautifully done. As a Parish Council we were delighted to fund the project. Do visit, it's well worth it.

As you receive this newsletter, the Christmas lights and decorations will be going up, so it leaves me to send Seasons Greetings and to wish you all a happy New Year.

*Elaine Best – chairman@westhorsley.info*

### PARISH COUNCIL GRANTS

Every year, the Parish Council gives grants to organisations who provide services within West Horsley. If your organisation would like to be considered, please contact the Clerk for an application form [clerk@westhorsley.info](mailto:clerk@westhorsley.info). Closing date for submissions for the 2023 grants is 31st December.

### THE WEST HORSLEY PARISH COUNCIL AWARDS

The Parish Council is planning a NEW Special Awards Evening to recognise individuals and groups who have done exceptional work to support and improve the lives of people living in West Horsley. The special presentation evening will be in March at West Horsley Place. Should you wish to nominate a person, group or organisation, for going above and beyond for their Village community, then please visit our website in the New Year to complete the on-line form. Alternatively, you can pick up a paper copy at Horsley Library or via our Clerk at [clerk@westhorsley.info](mailto:clerk@westhorsley.info) or 01483 901905. This will be our opportunity to recognise, value and thank those who do so much in support of others living in West Horsley. All information is on our website.



*Yew berries on the village green*

### CONTACT DETAILS & CREDITS

#### Parish Clerk and Responsible Financial Officer:

Julia McClung, Clerk, West Horsley Parish Council, 99 The Street, West Horsley, KT24 6DD

01483 901905, [clerk@westhorsley.info](mailto:clerk@westhorsley.info)

**Editor:** Vanessa Buosi, [cllrbuosi@westhorsley.info](mailto:cllrbuosi@westhorsley.info)

**Design and artwork by:** The Creative Workshop  
01580 212551, [www.tcws.co.uk](http://www.tcws.co.uk)

**Print by:** Simply Print Partners, 07768 228079,  
[www.simplyprintpartners.com](http://www.simplyprintpartners.com)

**Photographic Editor:** Cllr Vanessa Buosi

*The views or opinions expressed do not necessarily reflect those held by WHPC.*

Front Cover: Taken by Editor

The  
Henry Smith  
Charity  
founded in 1628

### WEST HORSLEY HENRY SMITH CHARITY FINANCIAL HELP

Please remember that our historic Village Parish Charity can give small grants to residents in need. Please make a request, in confidence, via the [clerk@westhorsley.info](mailto:clerk@westhorsley.info) or Tel 01483 901905.



Support your local Village shop  
[www.thecharcuteriebox.co.uk](http://www.thecharcuteriebox.co.uk)



# TASK GROUPS COVERING YOUR VILLAGE

Regular Task Group meetings are held in addition to official Parish Council and Committee meetings. Here is an update from each Task Group, including the name and email for the lead councillors who you can contact if you have a query.

## COMMUNICATIONS

We hope you enjoyed the Welcome to the Village Pack, which you can also download digitally. In the meantime, we do encourage signing up to our mailing list as we have our regular E-Bulletin Boards going out only digitally in between our hard copy newsletters. Should you wish to suggest a feature/subject in our newsletter please email and if suitable we can do our utmost to include!

*Vanessa Buosi – [cllrbuosi@westhorsley.info](mailto:cllrbuosi@westhorsley.info)*

## FINANCE

This is the time of year when budget setting for the following financial year takes place, the other committees and task groups of the Council being asked for an estimate of their requirements for 2024/25. This can be difficult as there are always unexpected costs, the Wisley Appeal for example. Although the Council had the foresight to keep unused funds of about £9,000 from the previous unsuccessful appeal by Wisley Investment Properties to one side so the cost to this year's precept is not as high as it might otherwise have been. The 2024/25 draft budget is due to be approved at the 12th of December 2023 Council meeting prior to being submitted to Guildford. The Council will do its utmost to keep any increase in the precept as low as possible.

*Frances King – [cllking@westhorsley.info](mailto:cllking@westhorsley.info)*



## THE COMMUNITY

The Community Task Group has recently had a very busy time of it. Despite soaring temperatures in September, The Teddy Bears' Picnic attracted some parents and children who seemed to have thoroughly enjoy themselves. John Irwin's stories and games were a hit, as always. Our "audience" appreciated the discovery of our lovely Village Orchard too. December promises to be even busier with the dressing of the Christmas trees on Silkmore

Triangle and the Village Green on Dec 2, followed the next day by the Annual Lantern Parade at West Horsley Place.

*Mel Beynon – [cllrbeynon@westhorsley.info](mailto:cllrbeynon@westhorsley.info)*



*New umpires chair at Village Tennis Court*



## ASSET & APPEARANCE

Things are happening in the Village, with the advent of the 2 new VAS signs to monitor speeding vehicles in The Street, and the new 'West Horsley' ironwork village sign which is to be installed on the Village Green. We are particularly proud of the latter, as we feel it is something that has been lacking in our Village for a while, particularly when compared to surrounding villages in the

Surrey Hills. Elsewhere the Orchard is now looking spectacular, and we are looking into the possibility of installing low level and dark sky compliant floodlighting on the tennis court. A constant problem at this time of year is hedges which block the pavement and drains which need clearing so please look out for any problems and be a good neighbour if your property is relevant. Our Village Warden Steve Peach is doing a great job keeping the village neat and tidy so please let us know if you feel anything needs urgent attention.

*Tony Rogers – [cllrogers@westhorsley.info](mailto:cllrogers@westhorsley.info)*



## ROAD SAFETY & MAINTENANCE

Our village seems to have had more than its fair share of roadworks of late, exacerbated by the A3/M25 works and traffic diversions, but we are pleased to report some positive outcomes following many of these frustrating road closures. Significant drainage improvements were installed at The Street, a location which suffers annual flooding and road closures. Recent storms have certainly put it to the test! The new drainage carried the surface water away far more efficiently than in previous years and, although there was temporary flooding one morning, it had cleared within 20 minutes. We are talking to Surrey CC about the possibility of additional drainage capacity closer to the railway bridge and will continue to monitor the situation. However, we are pleased that initial indicators are looking positive, and hopeful that the days of road closures and flooding at this location are over!

*Jane McKenzie – [cllrjmcckenzie@westhorsley.info](mailto:cllrjmcckenzie@westhorsley.info)*





# West Horsley Youth Council



Despite the interruption from revision and in some cases exams, the Youth Council continues to meet regularly and is growing in confidence. A recent "brainstorming session" between the normal meetings has resulted in new and improved campaigns.

The Youth Council may be small, but we are stronger than ever with a new member, Felicity, joining us in October. We have recently refreshed our noticeboard on East Lane; it is now an eye-catching lime green which stands out very visibly.

We have a full programme of events for 2024 following on from our sold-out screening of **Home Alone** on 8th December. In January we are

starting with the 'Good Neighbour Challenge', a community engagement project for primary-aged children. The concept is to give the children reasons to look at their village more closely and learn more about it. We then plan to launch a 'Clothes Swap' in Spring to promote sustainable fashion among teenage residents.

We're also excited to announce that the Horsley Hustle fun run event which attracted 120+ participants in June will return in 2024 and we hope it'll be bigger and better than the first!

Updated information will be launched on Nextdoor and via the Parish Council E-mailings and Bulletin Boards. Alternatively, keep an eye on the website [www.westhorsley.info](http://www.westhorsley.info) under Youth Council.

We hope that these initiatives will engage local young people of all ages and their families across a wide range of purposes. With the Youth Council having been run for almost 3 years now, we hope 2024 will be our best year yet! If you are aged between 13 and 18 and live in West Horsley, do give a thought to becoming a Youth Council Member.

It looks brilliant on your CV and helps towards your D of E too. More than that, it is your community, have a say in what happens in it!, please email:

[Mel Beynon – cllrbeynon@westhorsley.info](mailto:Mel.Beynon@westhorsley.info)  
[Vanessa Buosi – cllrbuosi@westhorsley.info](mailto:Vanessa.Buosi@westhorsley.info)

*"The Horsley Hustle fun run event which attracted 120 – participants in June will return in 2024."*

**APPLETREE**  
STUDIO

Thank you to Appletree Studios at Bishopsmead Parade, East Horsley for providing all the Youth Council lucky dips during the Horsley Big Day out where we had a stall. [www.theappletreestudio.co.uk](http://www.theappletreestudio.co.uk)



**CAN YOU HELP TO INFORM OUR HORSLEY COMMUNITY CLIMATE ACTION PLAN BY COMPLETING OUR QUICK SURVEY?**

Residents and local businesses are invited to scan the QR code to access our short survey online.

Thank you.  
We greatly appreciate your input.  
Paper copies can also be Found at Horsley library.

@the\_horsleys\_can /HorsleysCAN

**The Horsleys' C.A.N.**  
Climate Action Network Group

**WEST Horsley Place**

Thank you to West Horsley Place for allowing us to use your fabulous facilities for our Major Events, The Fun Run and Cinema Night.  
[www.westhorsleyplace.org](http://www.westhorsleyplace.org)

**Spring Reach Nursery**

Another Thanks to Spring Reach Nursery for supplying our Trees for the Cinema night, bringing the outdoors inside!  
[www.springreachnursery.co.uk](http://www.springreachnursery.co.uk)

**Join our Mailing List**



## OUR LOCAL ENVIRONMENT

# GRACE & FLAVOUR COMMUNITY KITCHEN GARDEN

This year has been a good one at the Grace & Flavour Garden. We have had bumper crops of fruit and vegetables. It has been a great growing year. A section was put aside to grow crops for a local food bank, and they have been very appreciative of the vegetables supplied. A major project was the paving of the area under our pergola where we take our refreshments outside in the summer. This was done entirely in house by our building team and was completed in time for our NGS Open Day and was much appreciated by our 200+ visitors. There are 2 half plot allotments currently available. Please contact the clerk at [clerk@westhorsley.info](mailto:clerk@westhorsley.info) if you are interested.

[https://www.graceandflavour.org/about\\_us.php](https://www.graceandflavour.org/about_us.php)



## HORSLEY MEDICAL PRACTICE

We will be starting a new joint venture with our PCN (Primary Care Network) on a Thursday morning at East Horsley Village Hall. It is a leg ulcer club called 'Legs Get Together' where practice nurses, tissue viability nurses and other Health Care Professionals will be available to dress and look after patients with leg ulcers. As well as clinical help, it will also provide a social setting for people to chat with a cup of tea and cake. We held a very successful well attended Men's Health evening at the end of September. The feedback forms were all extremely positive. As a practice we plan to hold similar events in the 2024 on different health issues. We are also in the process of looking into arranging an Open Day for anyone who is interested in how the practice is run and what goes on behind the scenes! For more information, please keep a look out on the practice website. In the meantime, we are getting a high number of DNA's (Patients who do not attend their appointments and have not cancelled). Appointments can be cancelled on your NHS app or by phoning the surgery allowing us to offer the appointment to other patients. On a seasonal note, if any artists are reading this and would be interested in volunteering to provide seasonal art on the glass at the front of our building, please contact Rosie at the surgery! Thank you.

<http://www.horsleymedicalpractice.nhs.uk/>  
01483 284151

# LITTER PICK AROUND THE VILLAGE

After a few weeks gap we were straight into the Autumn Litter pick on Oct 28th. This time the extreme opposite weather conditions threatened to make things difficult. As it turned out, the early rain moved out of the way and left us bathed in sunshine. We later celebrated a successful Litter Pick with refreshments and chat in the Village Orchard.





## THEN & NOW SPECIAL

### ROADS MAINTENANCE AROUND WEST HORSLEY

We have been working hard to secure funds for major repairs to the pavements in Northcote Crescent and the results are a huge improvement. The pavements are now even, wide, and safe to walk on. Hedges and tree stumps that encroached on the footway have been removed or cut back. We also pushed for works to repair pavements in Mount Pleasant, where the surface was dangerously uneven. As well as our highways, the village's network of footpaths and bridleways need maintaining. Our Councillors have identified those that need resurfacing, vegetation cutting back or replacement signage and will work with Surrey's Countryside Access team to ensure these works are delivered. There is still much to do, and the team are already working to secure future funding for other areas requiring attention.



Mount Pleasant Before & After



Northcote Before & After



### VILLAGE GREEN MAINTENANCE

The Village Green has had its fair share of damage over the years. Looking glorious now with all the planting done by the Parish Council using the Akkerman bequest, we can remind ourselves why we appreciate those who care about our immediate surroundings. The photos speak for themselves.



### ROAD SAFETY AROUND WEST HORSLEY

The Parish Council have ordered 2 new VAS (vehicle activated signs) to replace the existing 2, located opposite the Village Hall and at the junction of the Street and Cranmore Lane, which are old stock and outdated having been gifted to us by Guildford Borough Council a few years ago when they replaced theirs. The new signs will have 'smiley faces' and speed indicators to alert drivers travelling along The Street as to what their speed is and remind them that (at present) it's a 30mph speed limit. Whilst it will not completely deter drivers from speeding altogether the brighter displays will be more noticeable, and also have the benefit of allowing us to collect data on when a vehicle is speeding – at any time of day or night – and the speed at which they are travelling, which is useful evidence to send to the police and Surrey County Council.

### VILLAGE HALL MAINTENANCE

You may or may not have noticed but our Village Hall has had a face lift and been changed from Pink to Green. We hope you all prefer the Green!





# OUR VILLAGE – THEN & NOW

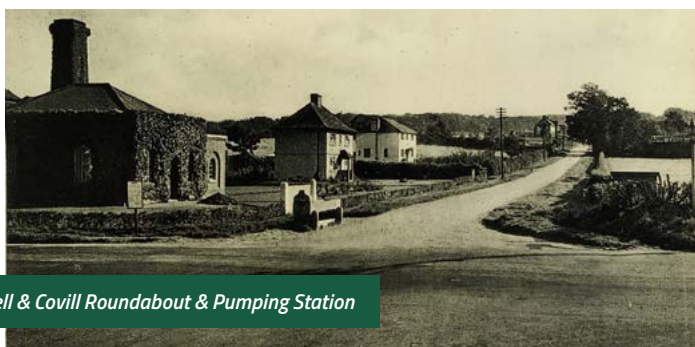

Bell & Covill Roundabout & Pumping Station



Brittain's Farm



The Street



Village Green



The King William IV Pub





# WEST HORSLEY PLACE RESEARCHING WORLD WAR II

West Horsley Place Trust have teamed up with Royal Holloway to learn more about the history of the manor house. The Bamber Gascoigne Bursary gives a student on the history programme the chance to come to West Horsley to undertake research.

It will both add to the Trust's knowledge and help a student on their first steps into a heritage career. Hannah, the first student to receive this new bursary, chose to look at the 1940s and in the process has uncovered some incredible things!

One astonishing fact was just how close West Horsley Place came to being destroyed by a bomb. West Horsley, as a reception area for evacuees, was considered to be relatively safe and Anderson shelters, the shed-like corrugated iron shelters, were not provided to the people in the village.

However, at the end of November 1940, four bombs fell very close to the house. Hannah

uncovered a document sent from Messenger and Morgan – a land agent – to the Marchioness of Crewe. They wrote to inform her that a bomb had fallen right next to the house on 30 November 1940 and that it has caused a crater and damage to the greenhouses, saying "it is a miracle that no damage was done to the house".

They included a hand drawn map to show her the location. While doing her research Hannah said: "If those four bombs had dropped a second sooner, the house would have been destroyed.

It's alarming to think that the house, as it stands today, could have been blown to pieces. Its history, its contents and the stories hidden in its archive may have been lost entirely. "Luckily the house survived in 1940 and the West Horsley Place Trust are now hoping to conserve it for future generations.

Follow them at [westhorsleyplace.org](http://westhorsleyplace.org) as they uncover more stories in their archives.

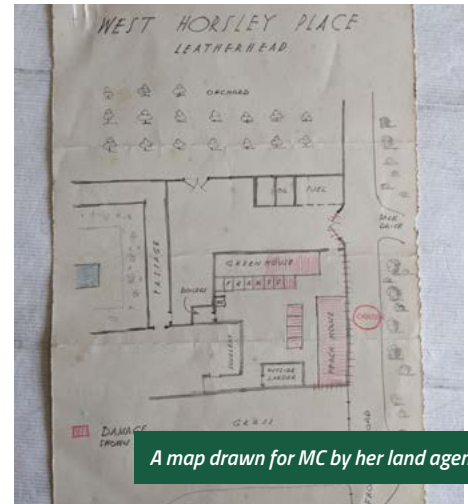

A map drawn for MC by her land agent



The bomb location today

West Horsley Place Then And Now



## FRIENDS OF HORSLEY STATION UPDATE

Now well into their fifth year, the Friends of Horsley Station work closely with Station Master Richard Bunce and Southwestern Railway's Community Rail team. Here are just some of the actions agreed at the last meeting, held of course in the main waiting room: · All planters to get fresh planting with Spring'24,

· "Welcome to the Horsleys" sign being designed, giving alighting users a wealth of local information.

· Two more bird boxes (one for a robin) to be installed following this year's successful hatching and launch of 14 blue tits, Preparations to mark the station's 140th birthday underway with help kindly offered by WHPC's Youth Council, and finally plans already under way for publication of the Station's history. A plea to goes out for any old station photographs or postcards you may have.

· At the meeting, we rolled up our sleeves for an "Autumn snip back" blitzing the platform planters as well as the Horsley Cycles Garden. Interested in joining us? Contact [cllrbeynon@westhorsley.info](mailto:cllrbeynon@westhorsley.info) or [cllrogers@westhorsley.info](mailto:cllrogers@westhorsley.info)



## U3A OF THE HORSLEY'S

The u3a nationwide has more than 430,000 members bringing all the benefits that such numbers can provide. Horsley u3a boasts 57 groups covering a vast range of activities from autobiography to wine tasting to photography. These clubs are available to all members – and as many as they want.

Our meetings take place in many locations from members' houses to the South Coast and many overseas destinations depending on the club's interests. Physical activity can be strenuous or non-existent meaning people of all abilities will find something that suits them. We're open to all those who are not in full time employment – age is irrelevant. Our motto is "learn, laugh, live". Why don't you join us?

<https://www.horsleyu3a.org.uk>.

*Paul Dodgson*

Chair Horsley u3a



## ST MARY'S CHURCH "THEN AND NOW"

Many people today hearken back to the 'good old days' wistfully wanting to "make Britain great again". To be fair, it is not clear what this means. Economically, we are richer than we have ever been, and we generally live for longer. However, there are some things that were better in the past, one example being the value placed upon Marriage. To this end, St Mary's Church has just run a course to help strengthen marriages. It has been very popular with 15 couples attending the seven-week course - in person and on zoom – enabling them to invest in and enrich such an important relationship. Marriage is a fundamental building block for society and so the slogan, 'make marriage great again' is perhaps a better slogan for today. We'll run the course again next year and we'd love to welcome you to it.



Wedding photography by Louise Adby

## WOMEN'S INSTITUTE (WHEWI) WI FETE FOR YOUNG FAMILIES

WI Fete for Young Families. The Village Orchard was the setting for a summer afternoon of family fun arranged by West Horsley Women's Institute. Visitors relaxed amidst the fruit trees and the wildflower and grassy areas, all shielded by the surrounding native hedgerow.

Young and old alike enjoyed potato printing, stencilling, and lots of gluing to make lovely woodland-themed creations. A lucky dip, hook the duck and pin the tail on the squirrel were as popular as ever. Picnic blankets were spread, and the benches were occupied as snacks were unpacked and home-baked goodies from the traditional WI cake stall were enjoyed. Lots of bunting, the odd glimpse of sunshine, and happy smiling faces completed the charm. West Horsley WI members thank West Horsley Parish Council for use of the Orchard and for a grant toward costs of putting on the event.

We are always delighted to welcome visitors and new members. Please contact us via email [westhorsleywi@btinternet.com](mailto:westhorsleywi@btinternet.com) or telephone Sue 01483 281669

<https://surrey.thewi.org.uk/find-wi/west-horsley-evening>



## COMMUNITY FORUM

"What's happening?" "I've heard that..." "What are you going to do about it?" These are questions and comments that are often heard when people talk about local issues. Rumours abound and it's sometimes difficult to get hold of the facts. "How many houses?" "Have you heard about these new roadworks". Even more of the questions that we as Parish Councillors are routinely asked?

The Parish Council decided in 2022 to try and do something about it. Where we think there is an issue that is worrying our residents, and we can try and provide information we will. We've held two Community Forums so far. Our first concerned Education. It focused on the concerns that some local children were not able to get

places at the Raleigh and also how the new housing could affect local education generally.

The second again concerned the impact of new housing this time upon the health services that we depend upon. Both provided answers and some new questions as well. Both, we felt, were informative and well received. We're happy to hold more, but obviously only if they could be useful. If you have any suggestions as to the topics that a Community Forum could deal with, please get in touch with us.

We don't want our residents to rely on rumours if we can provide facts.

*Cllr Paul Dodgson – [cldraddgson@westhorsley.info](mailto:cldraddgson@westhorsley.info)*





# THE HORSLEYS COMMUNITY BUS

The Horsleys Community Bus Association was founded as a charity around 25 years ago, having inherited an under-utilised minibus from Surrey County Council on the understanding that the charity would use it to provide community transport in the Horsley area. 5 or 6 minibuses later, today's 'bus' is comfortable and designed for easy access enabling the elderly to get out and go shopping, whilst socialising with friends en-route. Having a lift for disabled passengers, it also takes residents from 3 local care homes on countryside outings and café trips as well as providing regular transport for local social groups & organisations.

The minibus is busier than ever, being in regular use 5 or 6 days a week, with over 20 volunteer drivers. However, there is still space

for more passengers on shopping trips. For more information about our services please contact Kelvin Hayes (Chairman) on [07530167283](tel:07530167283)



PLEASE LET THE PARISH COUNCIL KNOW IF YOU WOULD LIKE TO HAVE A **HALLOWEEN EVENT IN 2024**

**HORSLEY CHORAL SOCIETY PRESENTS**  
**Come & Adore**  
 Saturday 16th December 2023 — 7.30pm  
 St Andrew's Church, Cobham KT11 3EJ  
 Vivaldi 'Gloria' together with Christmas carols  
 TICKETS: ADULT £16 UNDER 18 £8  
 BOX OFFICE: 07444 722318  
 ALSO AVAILABLE FROM CHOIR MEMBERS @ ON THE DOOR  
 Retiring cash collection in aid of  
 SENSORY SERVICES SIGHT FOR SURREY  
[www.horsleychoralsociety.com](http://www.horsleychoralsociety.com)

## THEATRE IN THE VILLAGE Disney was 100 in Oct 2023

Whippets will be back in March 2024 with a production of Frozen JR. Rehearsals are well underway, and the cast is looking forward to a choreography bootcamp in December. The first of our hand painted backdrops is almost finished, and our wardrobe team is busy with sewing 50+ costumes. Whippets' shows are run entirely by volunteers and our fabulous cast families to bring our shows to the stage. Next year we will be looking to add senior creatives to the team. If you know anyone who might be interested in taking on the musical director, choreographer, set design, producer or director roles please ask them to get in touch with Julia at [whippets.horsley@gmail.com](mailto:whippets.horsley@gmail.com). Tickets for Frozen JR. will go on sale in the New Year at [www.ticketsource.co.uk/whipstheatre](http://www.ticketsource.co.uk/whipstheatre)

## CHORAL SOCIETY CHRISTMAS CONCERT – 'COME & ADORE'

Come and start your Christmas festivities with Horsley Choral Society on Saturday 16th December at St Andrew's Church, Cobham (7.30pm) for a performance of Vivaldi's 'Gloria' together with Christmas carols for all. The choir will be joined by professional soloists, Jane Searle (soprano), Elizabeth Searle (mezzo-soprano), John Upperton (tenor), Geoffrey Horton (bass-baritone) and pianist Matthew Rickard. There will be a cash retiring collection in aid of Sight for Surrey who provide highly specialised support for those in Surrey with sensory loss. Tickets are available from the box office: 07444 722318 or from choir members and on the door. Adults £16 Under 18 £8. New members are always welcome to join the choir, for further information please visit [www.horsleychoralsociety.com](http://www.horsleychoralsociety.com), call 01372 457987 or email [secretary@horsleychoralsociety.com](mailto:secretary@horsleychoralsociety.com) No audition is required, just the ability to hold a tune and a love of singing. New term starts Monday 8th January at East Horsley Village Hall (8-10pm)

A WHIPPETS Production  
 Directed by Nicola Fawcett  
 DISNEY FROZEN JR.  
 Book by Jennifer Lee  
 Music & Lyrics by Kristen Anderson-Lopez & Robert Lopez  
 Based on the Disney film written by Jennifer Lee  
 21-23 MARCH 2024  
 WEST HORSLEY VILLAGE HALL  
 Tickets on Sale in the New Year at [www.ticketsource.co.uk/whipstheatre](http://www.ticketsource.co.uk/whipstheatre)

## HORSLEY WHEEL OF CARE

West Horsley Wheel of Care and East Horsley Care have been independent organisations conducting similar services for over twenty years to people residing in the parishes of West and East Horsley.

In May of this year the two organisations decided to merge, creating one, new organisation - Horsley Wheel of Care - to support the single community of Horsley. This new service was launched in August of this year.

Our primary aim is to provide transport to doctors, dentists and hospital appointments, hairdressers, shops, and our clubs. We also offer a sitting service to give care providers a break and provide company to people living on their own. In addition, we give information about other local services available where appropriate. We are an independent charity, managed and supported solely by volunteers.

New clients and volunteers are always welcome - please ring [07788552767](tel:07788552767) between 10 am and noon Monday to Friday.



## PLANNING MATTERS

# A STORY ABOUT A GLIMPSE INTO THE FUTURE THE REALITY OF LIFE IN WISLEY NEW TOWN?

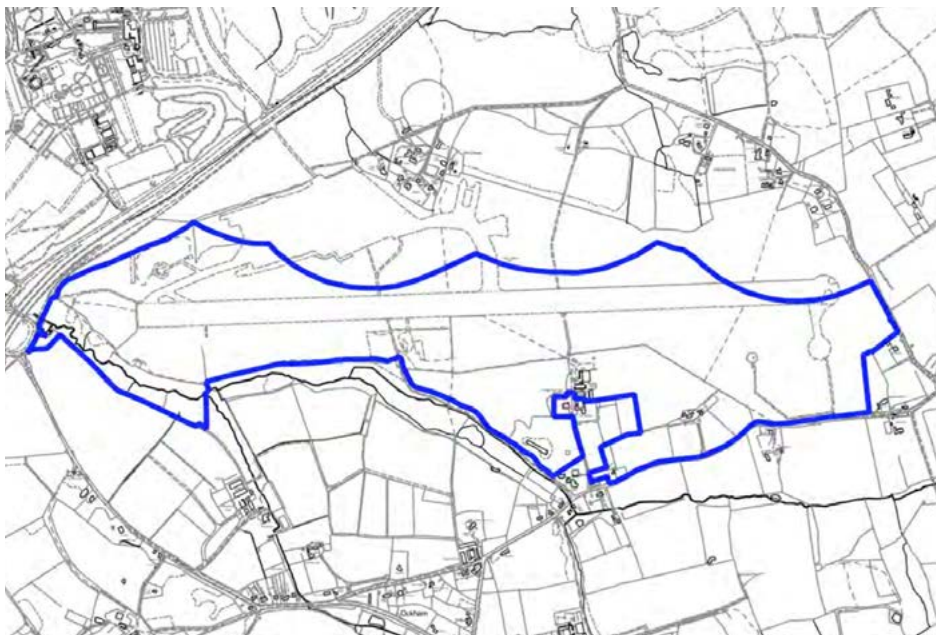

Mr and Mrs Average are very excited by the prospect of the new Wisley development and put down an early deposit to secure one of the best houses. They are moving to Taylor Wimpey's new town, and TW's brochure advertises "excellent schools in the vicinity" (which there are) and local shops in the nearby villages, as well as an on-site convenience store. A "medical facility" is also advertised, with the promise of a primary school "in due course", and TW assures them that by the time the development is open, everything will be in place. Mr Average works in London and commutes four days a week and has to be at work at 8.30am every day, entailing a train journey that starts at 7am. Mrs Average works

part-time in a care home. They have two young children, one needing a secondary school, one a primary school, and a pet dog. They cannot afford private education or private health and have to rely on state-funded facilities. They can't wait to start their new life in the country. However, when they move into their recently completed house in 2027, as one of the first occupants, the first thing they find out is that the 700 houses built in the area in the interim have taken up all the spare capacity from an already overloaded infrastructure. The local primary schools have a two-year waiting list (there is in fact only one, the Raleigh School in West Horsley) and finding a place at a local secondary school is an even bigger

problem. So, Mrs Average has to drive to Woking and back – twice a day, a round trip of over an hour until the on-site primary school is up and running. The local medical centres can't take any more NHS patients, and there is no room at either the local dentists or vets. The convenience shop in the new town lies empty as the retailers won't open until it becomes economically viable, i.e., until about 500 new homes have been sold, and there is still no sign of the 'medical facility'. Mrs Average can't find anywhere to park in either East Horsley or Ripley for local shopping so has to go to Guildford or Cobham. TW gives assurance that on-site facilities will be opened 'in due course'.

However, Taylor Wimpey has a well-documented history of only providing these facilities at the latest possible opportunity, and sometimes not at all. TW like most developers are not philanthropists and are purely motivated by greed and profit, at whatever cost. They will only build the social facilities (that don't make them money) at the last possible moment in their development programme.

In terms of commuting, there are no extra car parking spaces at either Horsley or Effingham Junction stations. Mr Average is a reluctant average cyclist and doesn't want to risk his life – 40 per cent of the year he will be cycling in the dark – among fast-moving traffic using Ockham Road or Old Lane which is just too dangerous. His only realistic option for cycling to get to Horsley station is via the Long Reach route, a circuitous journey with about 30 chicanes, subsidence, and numerous potholes which takes him over 25 minutes each way and involves crossing three major roads, as well as using a narrow footpath by the woods. His only other option for commuting is to rely on the WACT bus, which is infrequent and unreliable and doesn't make provision for travel outside peak hours. So inevitably Mrs Average will have to drive him to one of the stations and pick him up in the evenings, entailing four journeys every day along either Ockham Road or Old Lane before she takes the children to their respective schools. What will they do when all 2,100 new homes are built and there are likely 4,000 new residents all in the same boat?

*Tony Rogers*



*Three generations of families are concerned about where the meals of the future will come from if Three Farm Meadows goes under concrete and come together with VILLAGES AGAINST WISLEY NEW TOWN to object to this threat on a huge green field site adjoining former Wisley airfield.*

## PLANNING IN WEST HORSLEY

Our focus has been on Wisley, and any updates on planning in West Horsley can be found on our website. [www.westhorsley.info](http://www.westhorsley.info)  
*Guy Murray - [cllmurray@westhorsley.info](mailto:cllmurray@westhorsley.info)*





# West Horsley Parish Council

## HORSLEY CLUBS & ACTIVITIES

### ARTS

**Horsley & Clandon Society of Arts**  
 Robyn Cormack Tel: 01483 224063

**Horsley Craft Group**  
 Jody Fern Tel: 01483 284437

**The Arts Society Horsley**  
[www.theartssocietyhorsley.org.uk](http://www.theartssocietyhorsley.org.uk)

**The Arts Society Horsley Lovelace**  
[www.theartssocietyhorsleylovelace.org.uk](http://www.theartssocietyhorsleylovelace.org.uk)

### CLUBS

**University of the Third Age (u3a)**  
[www.horsleyu3a.org.uk](http://www.horsleyu3a.org.uk)

**East Horsley Women's Institute**  
 Helen Taylorson Tel: 01483 283577

**West Horsley Women's Institute**  
 Sue Tel: 01483 281669

**West Surrey Natural History Society**  
 Tel: 01372 457623

**The Probus Club of the Horsleys**  
 David Lush Tel: 01483 280267

**Rotary Club of Bookham & Horsley**  
 Mark Secker Tel: 01372 458733

**Grace & Flavour Community Garden**  
[www.graceandflavour.org](http://www.graceandflavour.org)

**East Horsley Bridge Club**  
[www.bridgewebs.com/easthorsley](http://www.bridgewebs.com/easthorsley)

**Horsley Floral Decoration Group**  
 Ruth Farmer Tel: 01483 202440

**Horsley Garden Society**  
 Terry Lazenby Tel: 01483 284232

**Beehive Craft Group**  
[www.easthorsleychurch.org.uk](http://www.easthorsleychurch.org.uk)

**Wheel of Care Social & Exercise Clubs**  
[www.westhorsleywheelofcare.co.uk](http://www.westhorsleywheelofcare.co.uk)

### DRAMATICS & CHORAL

**The Nomad Theatre**  
[www.nomadtheatre.com](http://www.nomadtheatre.com)

**The Whips Players**  
[www.whipstheatre.org](http://www.whipstheatre.org)

**Horsley Choral Society**  
[www.horsleychoralsociety.com](http://www.horsleychoralsociety.com)

### YOUTH

**Beavers, Cubs, Scouts & Explorer Scouts**  
[www.firsthorsley.co.uk](http://www.firsthorsley.co.uk)

**4th Horsley Brownies**  
 Email: [horsleybrownies@yahoo.co.uk](mailto:horsleybrownies@yahoo.co.uk)

**1st West Horsley Brownies**  
 Email: [westhorsleybrownies@gmail.com](mailto:westhorsleybrownies@gmail.com)

**1st Horsley Guides**  
 Karlenne Peach Tel: 01483 224692

### SPORTS & ACTIVITIES

**Sports facilities & Skatepark**  
 Kingston Meadow, Kingston Avenue

**The Horsley Shufflers – running group**  
[www.facebook.com/HorsleyShufflers](http://www.facebook.com/HorsleyShufflers)

**Horsley Football Club, West Horsley**  
[www.horsleyfc.co.uk](http://www.horsleyfc.co.uk)

**Effingham and Leatherhead RFC**  
<https://eaglesrugby.club>

**West Horsley Community Club Snooker & Pool**  
 Robert Elliott Tel: 07702 922217

**Effingham Table Tennis Club**  
 Tim Hobbs Tel: 01372 452197

**Horsley Tennis Club**  
[www.horsleysportsclub.com](http://www.horsleysportsclub.com)

**Horsley Badminton Club**  
[www.horsleybadminton.co.uk](http://www.horsleybadminton.co.uk)

**Horsley Cricket Club**  
[www.horsleysportsclub.com](http://www.horsleysportsclub.com)

**Effingham Cricket Club**  
[www.effinghamcc.co.uk](http://www.effinghamcc.co.uk)

**Horsley and Send Cricket Club**  
[www.horsleyandsendcc.co.uk](http://www.horsleyandsendcc.co.uk)



## Holly Tree

Traditionally, the Holly tree is highly sacred in Celtic mythology and symbolises **peace and goodwill**. Due to its resistance to lightning, it is associated with the Celtic and Norse gods of thunder, Taranis, and Thor, and so was planted near dwellings to protect people from lightning strikes.

Druids believed the Holly tree to possess protective qualities, such as guarding against evil spirits and bad luck. Legend has it that bringing the leaves inside during the winter months would provide shelter from the cold for fairies, who in return would be kind to those who lived in the l

In reality, the Holly tree's abundance of spiked leaves is a great spot for garden birds to safely make their nests, providing a natural protection from predators. These trees are also particularly wonderful in spring, as the delicate, scented flowers are

loved by bees and butterflies. Did you know that a Holly tree is either male or female, this becomes apparent as the tree matures; the male Holly tree has pale yellow flowers and the females are white! Only female trees produce berries, known as drupes.

An old wives tale warns that when the berries are plentiful (like they are this year!) the winter will be very cold. Lets hope is not too cold! Wrap up warm and enjoy the Holiday Season spotting the holly trees around the village.



## MEET THE TEAM

Join us at our Monthly meetings (third Tuesday of the Month) and have your say about your village! If you can't make it sign up to our mailing list to be up to date on current projects, events and issues affecting West Horsley.

## PARISH COUNCIL CONTACTS



**ELAINE BEST**  
 Chairman  
[chairman@westhorsley.info](mailto:chairman@westhorsley.info)



**FRANCES KING**  
[cllrking@westhorsley.info](mailto:cllrking@westhorsley.info)



**MEL BEYNON**  
[cllrbeynon@westhorsley.info](mailto:cllrbeynon@westhorsley.info)



**VANESSA BUOSI**  
[cllrbuosi@westhorsley.info](mailto:cllrbuosi@westhorsley.info)



**CAROLE MATTOCK**  
[cllrmattock@westhorsley.info](mailto:cllrmattock@westhorsley.info)



**PAUL DODGSON**  
[cllrdodgson@westhorsley.info](mailto:cllrdodgson@westhorsley.info)



**GUY MURRAY**  
[cllrmurray@westhorsley.info](mailto:cllrmurray@westhorsley.info)



**JANE MCKENZIE**  
[cllrmmckenzie@westhorsley.info](mailto:cllrmmckenzie@westhorsley.info)



**TONY ROGERS**  
[cllrrogers@westhorsley.info](mailto:cllrrogers@westhorsley.info)



**KAREN YOUNG**  
 Deputy Parish Clerk  
[deputyclerk@westhorsley.info](mailto:deputyclerk@westhorsley.info)



**JULIA MCCLUNG**  
 Parish Clerk  
[clerk@westhorsley.info](mailto:clerk@westhorsley.info)

## USEFUL TELEPHONE NUMBERS & WEBSITES

**Neighbourhood Policing team**  
 Tel: 101  
[guildford@surrey.police.uk](mailto:guildford@surrey.police.uk)

**GBC Refuse Collection**  
 Tel: 01483 505050  
[www.guildford.gov.uk](http://www.guildford.gov.uk)

**Slyfield Recycling Centre**  
 Tel: 01483 532187

**Guildford Borough Council**  
<https://my.guildford.gov.uk/customers/s/>

**Water Leaks**  
 Tel: 0345 357 2407  
[www.affinitywater.co.uk](http://www.affinitywater.co.uk)

**Gas Leaks**  
 Tel: 0800 11 99 99

**Electricity Power Cuts**  
 Tel: 0800 31 63 105 or 105 (Mobile)  
[www.ukpowernetworks.co.uk](http://www.ukpowernetworks.co.uk)

**Flooding & Waterways**  
[www.gov.uk](http://www.gov.uk)

**Environment incident hotline**  
 Tel: 0800 80 70 60  
[www.gov.uk](http://www.gov.uk)

**Surrey County Council**  
[www.surreycc.gov.uk/do-it-online/](http://www.surreycc.gov.uk/do-it-online/)

**SCC Highways Roads & Transport**  
[www.surreycc.gov.uk/roads-and-transport](http://www.surreycc.gov.uk/roads-and-transport)

**Floodline:**  
 Tel: 0345 988 1188